

PLANTING SCHEDULE & SOFT LANDSCAPE MAINTENANCE

SOFT LANDSCAPE WORKS PROGRAMME

November - March
Before main contract practical completion

- a. Bare root transplants, hedging and reseeded trees
- b. Containerised shrubs, perennials and grass lawns
- c. 12 months maintenance & defects liability period, to commence on practical completion of soft landscape works. Lawn cutting: 14 cuts per growing season (April - October) carried out on a fortnightly basis and 2 additional cuts over winter period. 16 cuts in total, 16 no. maintenance visits required.
- d. 12 months maintenance & defects liability period to planted beds, trees, hedges and transplant planting to be carried out at the same time as grass cutting, 16 no. maintenance visits required.

Trees
All trees to be provided with 1.2m² multi-purpose grade topsoil to BS3882 and planted as per planting details drawings, with root restrictor membrane where appropriate to ensure adjacent pavings/services are not disturbed by root growth, and provided with irrigation where appropriate.

- Alnus cordata 'Italian Alder' 20-25cm girth planted to Planting Detail A with root restrictor membrane near services routes/paving
- Pinus Chanticleer 'Pear tree' 18-20cm girth planted to Planting Detail A with root restrictor membrane near services routes/paving
- Betula pubescens 'Downy Birch' 18-20cm girth planted to Planting Detail A with root restrictor membrane near services routes/paving
- Betula pubescens 'Downy Birch' 20-25cm girth planted to Planting Detail A with root restrictor membrane near services routes/paving
- Sorbus aucuparia 'Rowan' 18-20cm girth planted to Planting Detail A with root restrictor membrane near services routes/paving
- Pinus sylvestris 'Scots Pine' 20-25cm girth planted to Planting Detail A with root restrictor membrane near services routes/paving
- Betula pubescens 'Downy Birch' 3-3.5m height multi-stemmed planted to Planting Detail A with root restrictor membrane near services routes/paving
- Corylus avellana 'Common Hazel' 2.5m height multi-stemmed planted to Planting Detail A with root restrictor membrane near services routes/paving
- Prunus spinosa 'Sloe' 2.5m height multi-stemmed planted to Planting Detail A with root restrictor membrane near services routes/paving

Shrubs & Perennials
Excavate to 400mm depth and backfill with 300mm multi-purpose grade topsoil to BS3882, and top with 90gsm black geotextile landscape weed-guard type fabric and 75mm depth medium grade bark.

Qty.	Species	Height (cm)	Pot Size	Density	Container-grown (cg) / Bare Root (br)	Quality Specification
P1 Low Growing Perennial Mix						
3 plants per m ²						
	<i>Alyx reptans</i> 'Cattins Giant'	40-60cm	2lt		cg	
	<i>Echinacea purpurea</i> 'Kims Knee High'	40-60cm	2lt		cg	
	<i>Rudbeckia fulgida</i> 'Goldsturm'	40-60cm	2lt		cg	
	<i>Rudbeckia maxima</i>	40-60cm	2lt		cg	
	<i>Penstemon angustifolia</i> 'Blue Spire'	40-60cm	2lt		cg	
	<i>Libertia grandiflora</i>	40-60cm	2lt		cg	
	<i>Eryngium agavifolium</i>	40-60cm	2lt		cg	
	<i>Ligularia 'The Rocket'</i>	40-60cm	2lt		cg	
	<i>Kniphofia caulescens</i>	40-60cm	2lt		cg	
P2 Midsize Perennial Mix						
3 plants per m ²						
	<i>Blechnum spicant</i>	40-60cm	2lt		cg	
	<i>Phyllitis (Asplenium) scolopendrium</i>	40-60cm	2lt		cg	
	<i>Polystichum aculeatum</i>	40-60cm	2lt		cg	
	<i>sarcococca hookeriana</i> var. <i>humilis</i>	40-60cm	2lt		cg	
	<i>Agapanthus 'Bressingham Blue'</i>	40-60cm	2lt		cg	
	<i>Echinacea purpurea</i> 'Kims Knee High'	40-60cm	2lt		cg	
	<i>Kniphofia triangulans</i>	40-60cm	2lt		cg	
	<i>Alcea rosea 'Hollyhock'</i>	40-60cm	2lt		cg	
	<i>Ligularia 'The Rocket'</i>	40-60cm	2lt		cg	
	<i>Rudbeckia maxima</i>	40-60cm	2lt		cg	
	<i>Penstemon angustifolia</i> 'Blue Spire'	40-60cm	2lt		cg	
	<i>verbascum bombyciferum</i>	40-60cm	2lt		cg	
	<i>eryngium aquilium</i>	40-60cm	2lt		cg	
P3 Shade tolerant Perennial Mix						
3 plants per m ²						
	<i>Astilbe chinensis</i>	40-60cm	2lt		cg	
	<i>Blechnum spicant</i>	40-60cm	2lt		cg	
	<i>Digitalis grandiflora</i>	40-60cm	2lt		cg	
	<i>Iris foetidissima</i>	40-60cm	2lt		cg	
	<i>Phyllitis (Asplenium) scolopendrium</i>	40-60cm	2lt		cg	
	<i>Polystichum aculeatum</i>	40-60cm	2lt		cg	
Single Species climber						
	<i>Lonicera japonica 'Hailiana'</i>	1m	2lt		cg	
	<i>Hedera helix</i>	1.5m	2lt		cg	

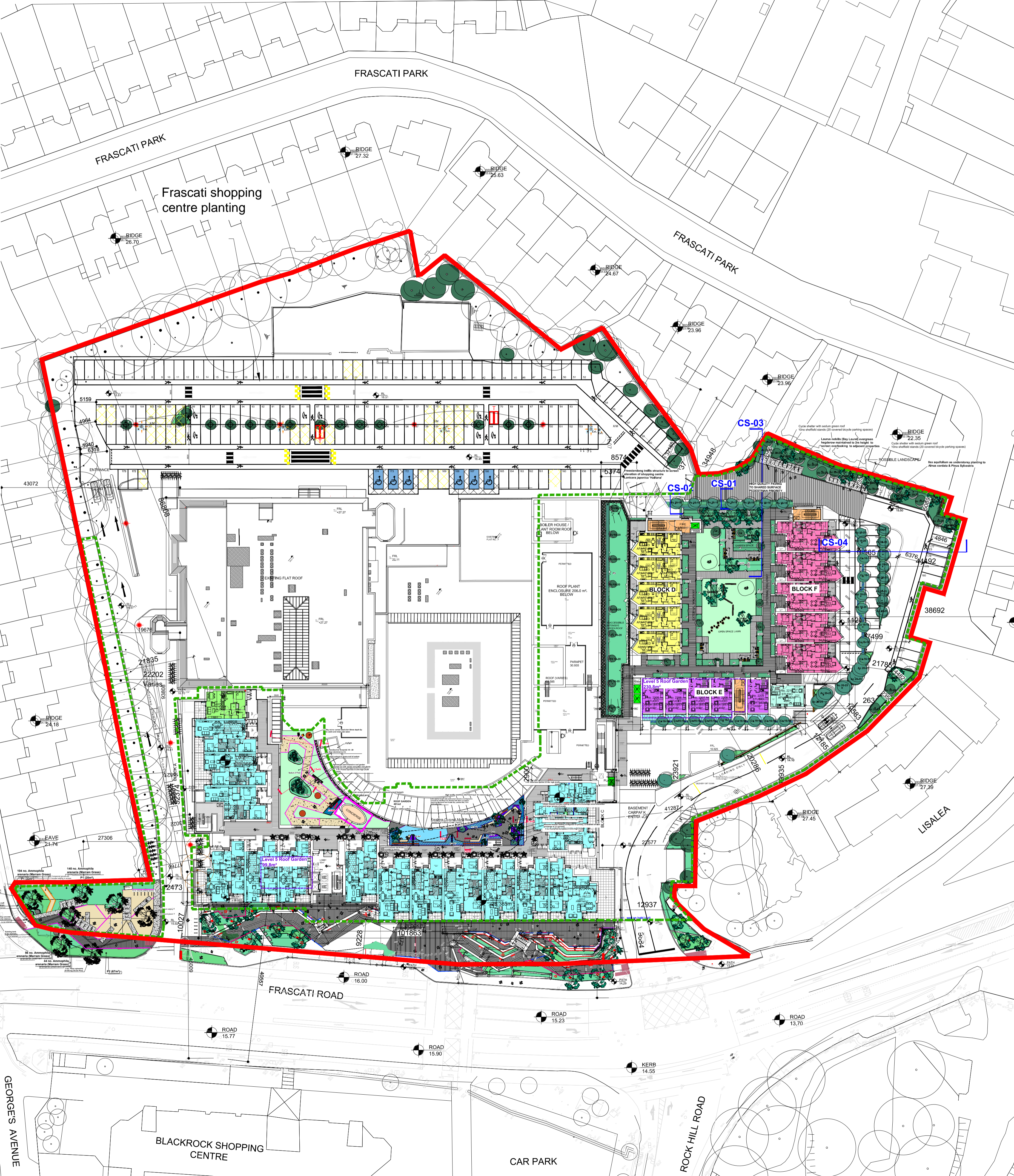

Rev/Date	Description	By

This drawing is copyright. Figured dimensions to be used in all cases. All dimensions to be checked on site prior to commencement of works.

SPECIFICATION KEY	
	Paving: Natural stone paving <ul style="list-style-type: none"> 95x80mm and 115x80mm flame-textured Irish blue limestone paving, sawn all sides, in random lengths 400, 600 and 900mm. 6mm joints to paving units to be filled with wet/slurry mix jointing material to BS:7533, colour neutral. Paving units to be laid on min 30mm wet mix bedding and priming mortars to BS:7533 on sub-base to engineer's design detail and specification. Apply two coats of clear sealer to prevent staining. Aluminium edging detail to perimeter.
	Q25/110 - PAVING: NATURAL STONE PAVING <ul style="list-style-type: none"> 95x80mm in random length of 200 x 400 x 600 mm flame-textured SILVER & DARK GREY GRANITE paving. 6mm joints to paving units to be filled with wet/slurry mix jointing material to BS:7533, colour neutral. Sub-base to engineer's design detail and specification. Apply two coats of clear wet lock sealer to prevent staining.
	RICHTER PLAY EQUIPMENT <ul style="list-style-type: none"> wild boar play element by Richter
	ORNAMENTAL SHRUBS AND PERENNIALS <ul style="list-style-type: none"> Planting to 300mm depth BS3882 multi-purpose topsoil on free-draining sub-base, topped with 90gsm black landscape fabric and 75mm depth medium-grade pine bark mulch. Ornamental perennial planting to comprise ornamental grasses & flowering perennials to soften the visual impact of the development.
	NATIVE & NATURALISED SPECIES TRANSPLANTS TO MATURE INTO WOODLAND COPSE & HEDGEROWS - MIXES AS PER LISTS ON PLANTING SCHEDULE.
	SEMI-MATURE NATIVE TREES <ul style="list-style-type: none"> Semi-mature native species provided with 1200mm² multi-purpose grade topsoil to BS: 3882, topped with black 90gsm² landscape fabric secured with plastic pegs at 300mm c/c's & 75mm depth medium-grade bark mulch. Trees double-staked & supplied with planting accessories, and provided with root restrictors within 2m of paving, underground services and foundations.
	CLEAR-STEMMED TO 2M HEIGHT SEMI-MATURE TREES <ul style="list-style-type: none"> Semi-mature trees provided with 1200mm² multi-purpose grade topsoil to BS: 3882, topped with black 90gsm² landscape fabric secured with plastic pegs at 300mm c/c's & 75mm depth medium-grade bark mulch. Trees double-staked & supplied with planting accessories, and provided with root restrictors within 2m of paving, underground services and foundations.
	Street Furniture: Wooden Seating <ul style="list-style-type: none"> 600 width x 400 depth mm to various lengths & shapes (as indicated in plan) planned smooth iroko seat units Timber to be FSC-certified and sourced sustainably. Frame of galvanised steel with stainless steel fasteners, bolted to C20P concrete foundations finished min 150mm below FGL.
	Grasses: Synthetic grass system <ul style="list-style-type: none"> Tufted fill synthetic grass carpet PE Monofilament curled (UV Stabilized) Environmentally friendly free of lead and cadmium Pile height of 10mm

Tree Planting Notes:
 Ac - *Alnus cordata* 'Italian Alder'
 Ps - *Pinus sylvestris* 'Scots Pine'
 Bp - *Betula pubescens* 'Downy Birch'
 Sa - *Sorbus aucuparia* 'Rowan'
 Pp - *Prunus padus* 'Bird Cherry'
 Pc - *Pyrus Chanticleer* 'Pear'
 Ps - *Prunus spinosa* 'Sloe'
 Ma - *Malus sylvestris* 'Crab Apple'
 Ca - *Coryllus avellana* 'Common Hazel' 2.50m height multi-stemmed

STEPHEN DIAMOND ASSOCIATES
 CHARTERED LANDSCAPE ARCHITECTS
 68 Pearse Street Dublin 2 tel: 01 6775670
 email: mail@sdacta.ie fax: 01 6775669
 Client - IMRF II Frascati Limited Partnership acting through its general partner Davy IMRF II GP Limited
 Project - Proposed Strategic Housing Development (Alterations to Phase 1 Residential and Proposed Phase 2 Residential Development)
 Title Landscape Master Plan & Planting Schedule Scale 1:500 @ A1
 Dwg No 19-524-PD-01 Date Issued 2020-08-24
 Drawn SD/LP Purpose Planning Checked SD